

# Quarq BB386 EVO Assembly Instructions

1. Remove the preload adjuster and aluminum spacer(4.84mm) from the non drive side crank arm/spindle. Set them and the drive side aluminum spacer(13.01mm) aside, they are not used for fitting to a BB386 frame.
2. Install wave washer onto the spindle followed by the thicker(3.2mm) black plastic spacer.
3. Insert spindle through the frame/bearings from the non drive side until the thicker(3.2mm) black plastic spacer and wave washer are sandwiched by the crank arm and bearing.
4. Place the thinner(2.5mm) black plastic spacer on the end of the spindle sticking out of the drive side bearing.
5. Place 2 qty. clear plastic(0.5mm) shims onto the end of the spindle sticking out of the drive side bearing.

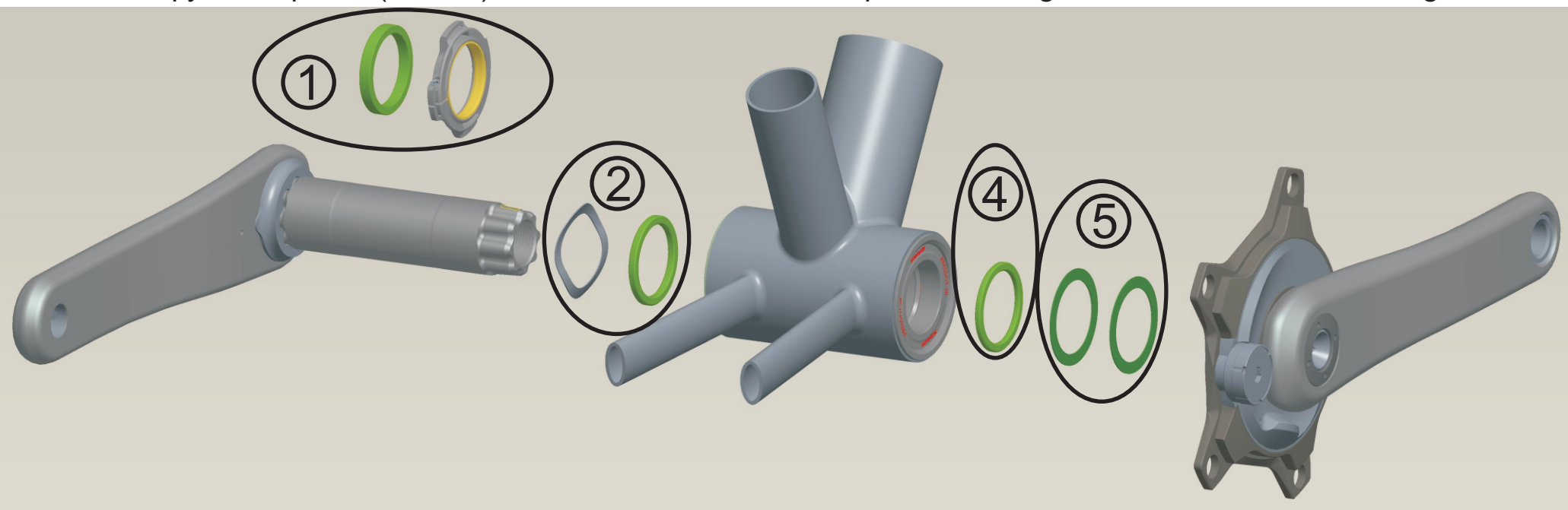

6. Use a torque wrench with an 8 mm hex bit socket to tighten the drive side crank arm bolt to 54 N·m (478 in-lb).
7. The wave washer should be compressed, but not flattened when the crank bolt is tightened to 54 N·m (478 in-lb). Check the crankset for excess drag in bearings and for play by rocking the crank arms back and forth. Add/Or remove clear plastic(0.5mm) shims to get proper compression on wave washer.

